

HOW TO SHARPEN AND USE THE STANLEY CABINET SCRAPER

STANLEY



1. TO SHARPEN A BEVEL EDGE SCRAPER BLADE REMOVE THE OLD BURR WITH A SMOOTH MILL FILE HELD FLAT AGAINST THE FACE OR FLAT SIDE OF THE BLADE.



2. FILE OR GRIND A BEVEL OF ABOUT 45°. PUSH THE FILE FORWARD AND TO THE SIDE WITH ONE SLIDING MOTION.



3. WHET THE BEVEL SIDE OF THE BLADE ON THE OIL STONE.



4. WHET THE FACE SIDE OF THE BLADE TO REMOVE THE WIRE EDGE.



5. DRAW THE EDGE WITH A FEW FIRM STROKES ON THE FACE SIDE OF THE BLADE. HOLD THE BURNISHER FLAT ON THE FACE SIDE OF THE BLADE.

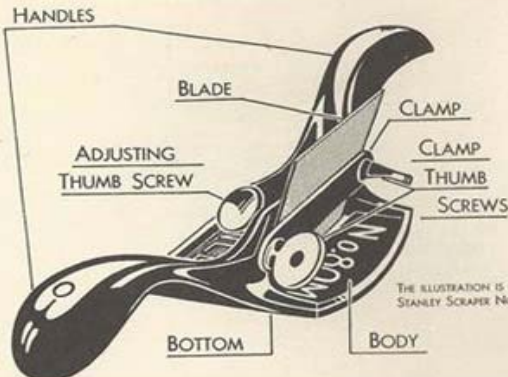

THE CABINET SCRAPER IS USED FOR THE FINAL SMOOTHING BEFORE SANDPAPERING. IT REMOVES THE SLIGHT RIDGES LEFT BY THE PLANE. IT IS ALSO USED TO SMOOTH SURFACES THAT ARE DIFFICULT TO PLANE BECAUSE OF CURLY OR IRREGULAR GRAIN.

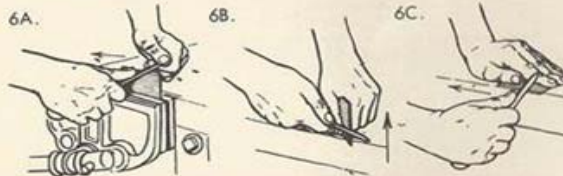

TURN THE EDGE WITH A FEW FIRM STROKES OF THE BURNISHER ON THE BEVEL SIDE OF THE BLADE. THE SCRAPER CAN BE HELD IN ANY OF THE THREE WAYS SHOWN ABOVE. DRAW THE BURNISHER TOWARD YOU THE FULL LENGTH OF THE BLADE, WITH A SLIDING STROKE. SOME PREFER TO STROKE BOTH WAYS FROM THE CENTER TOWARD THE ENDS. A DROP OF OIL ON THE BURNISHER HELPS.



THE FIRST STROKE SHOULD BE MADE WITH THE BURNISHER HELD AT AN ANGLE, A LITTLE GREATER THAN THE BEVEL INCREASE THE ANGLE UNTIL, AT THE LAST STROKE, THE BURNISHER IS HELD AT ABOUT 75° TO THE FLAT FACE OF THE BLADE. IF THE EDGE SHOULD BE TURNED TOO FAR OVER, IT CAN BE RAISED BY DRAWING THE POINT OF THE BURNISHER ALONG THE EDGE, UNDER THE BURR.

STANLEY



TO ADJUST AND USE THE CABINET SCRAPER, LOOSEN THE ADJUSTING THUMB SCREW AND THE CLAMP THUMB SCREWS. INSERT THE BLADE FROM THE BOTTOM WITH THE BEVEL SIDE TOWARDS THE ADJUSTING THUMB SCREW.



BRING THE EDGE OF THE BLADE EVEN WITH THE BOTTOM OF THE SCRAPER BODY, BY STANDING IT ON A FLAT SURFACE AND PRESSING THE BLADE LIGHTLY AGAINST THE WOOD. TIGHTEN THE CLAMP THUMB SCREWS a, a. BOW THE BLADE BY TIGHTENING THE ADJUSTING THUMB SCREW b, TO MAKE IT PROJECT ENOUGH TO TAKE A THIN SHAVING. IF ONE CORNER OF THE BLADE PROJECTS TOO FAR, IT CAN BE DRAWN IN BY TAPPING THE SIDE OF THE BLADE NEAR THE TOP.



TRY THE SCRAPER AND CHANGE THE ADJUSTMENT UNTIL IT TAKES A THIN EVEN SHAVING. HOLD IT TURNED A LITTLE TO THE SIDE TO START A CUT. THE CABINET SCRAPER IS USUALLY PUSHED BUT IT CAN BE PULLED. DUST, INSTEAD OF A SHAVING, INDICATES A DULL SCRAPER.

STANLEY TOOLS
NEW BRITAIN, CONN., U.S.A.

EDUCATIONAL DEPARTMENT
CHART NO. 29

BY R. G. REDER

PRINTED IN U.S.A.